

REV	DESCRIPTION	BY	CHK	DATE	ECN
A	ENGINEERING RELEASE	DLL	SSW	12-13-02	42349

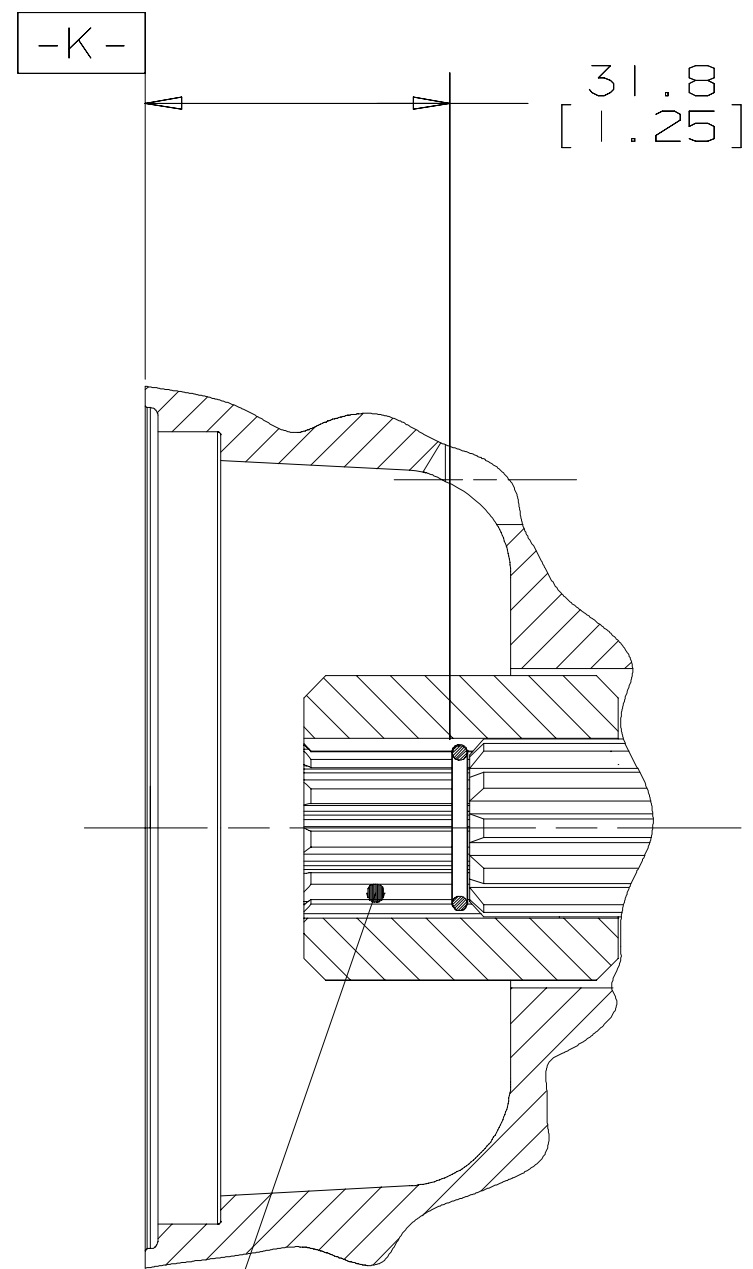

11 TOOTH 16/32 P 30°  
 INVLT FLAT ROOT CLASS I  
 SIDE FIT SPLINE SAE J498b

ADDITIONAL UNITS DRIVEN BY  
 THIS SPLINE MUST NOT REQUIRE  
 MORE THAN 118 N·m [1050 lbf·in]  
 OF TORQUE

G H

UNLESS OTHERWISE SPECIFIED ALL DIMENSIONS ARE IN INCHES <input type="checkbox"/> MILLIMETERS [INCHES] <input checked="" type="checkbox"/>	DRAWING BASED ON ANSI Y14.5M-1982	
	THE REPRODUCTION, DISTRIBUTION, AND UTILIZATION OF THIS DOCUMENT, AS WELL AS THE COMMUNICATION OF ITS CONTENTS TO OTHERS WITHOUT EXPLICIT AUTHORIZATION IS PROHIBITED. OFFENDERS WILL BE HELD LIABLE FOR THE PAYMENT OF DAMAGES. ALL RIGHTS RESERVED IN THE EVENT OF THE GRANT OF A PATENT, UTILITY MODEL, OR DESIGN. (PER ISO 16016)	
TOLERANCES .X ± --- .XX ± REF .XXX ± ONLY < ± ---	DRAWN BY/DATE DLL 9-19-02 CHECKED BY/DATE SSW 12-18-02 ENGRG BY/DATE SSW 12-18-02 METALLURGY BY/DATE ---	MATERIAL/HEAT TREAT  TITLE SHAFT INSTALLATION
UNSPECIFIED RADII ARE ---	<input type="checkbox"/> MICROINCHES <input type="checkbox"/> MICROMETERS [MICROINCHES] <input checked="" type="checkbox"/> ARITHMETICAL AVERAGE	NUMBER A-448-042
UNSPECIFIED DRAFT ANGLES ARE ---	<input checked="" type="checkbox"/> THIRD ANGLE PROJECTION DO NOT SCALE	SCALE 1/1 SHEET 1 OF 1
DRAWING FORMAT CADD <input checked="" type="checkbox"/> MANUAL <input type="checkbox"/>		

