

AEROQUIP PART NUMBER	WEATHERHEAD PART NUMBER	TH'D "P"	A REF
2080-16-16S	C3959X16	1-11 1/2	41.1 [1.62]
2080-12-12S	C3959X12	3/4-14	34.5 [1.36]
2080-8-8S	C3959X8	1/2-14	31.2 [1.23]
2080-6-6S	C3959X6	3/8-18	25.9 [1.02]
2080-4-4S	C3959X4	1/4-18	22.4 [.88]
2080-2-2S	C3959X2	1/8-27	16.8 [.66]

(K)

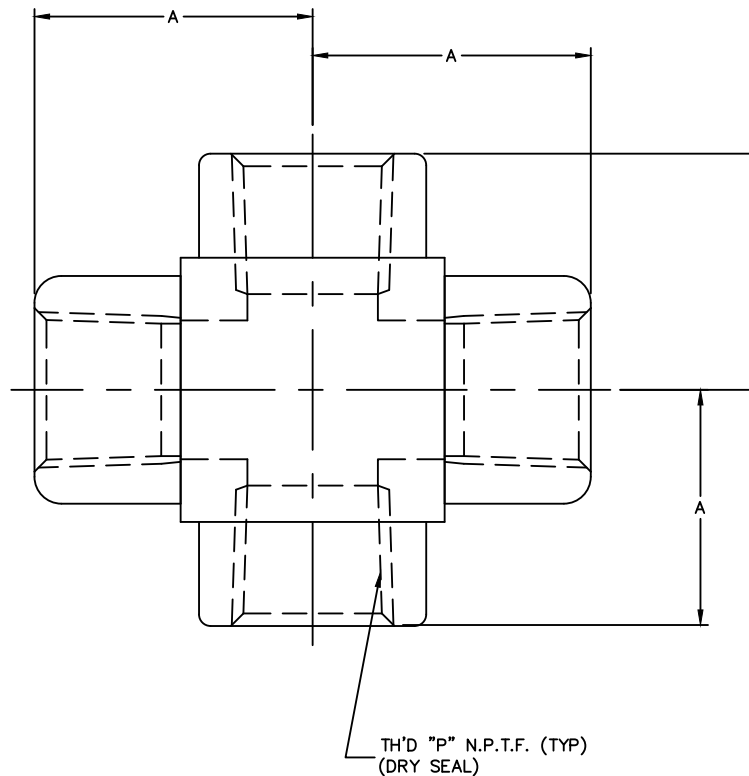

REVISIONS			
REV	DESCRIPTION	DATE	APPROVED
K	REDRAWN, UPDATED TO DANFOSS FORMAT. 1) ADDED WEATHERHEAD PART NUMBERS	2009-12-29 VJS/ADN	0038676-ECO

METRIC

2. DIMENSIONS ARE IN MILLIMETERS [INCHES].

1. DETAILS OF CONTOUR AND METHOD OF FABRICATION ARE OPTIONAL WITH MANUFACTURER.

DRAWN V. SURYAWANSHI CHECKED A. NAGARKATTI APPROVED A. NAGARKATTI RELEASE DATE 2009-12-29 0038676-ECO	FLUID CONVEYANCE DIVISION DRAWING TITLE ADAPTER CROSS-FEMALE PIPE
THIRD ANGLE PROJECTION 	SIZE A2 SCALE NONE DIST U CAGE CODE 01276 SHEET 1
DRAWING NUMBER 2080-S REV K	
<small>THE REPRODUCTION, DISTRIBUTION AND UTILIZATION OF THIS DOCUMENT AS WELL AS THE COMMUNICATION OF ITS CONTENTS TO OTHERS WITHOUT EXPLICIT AUTHORIZATION IS PROHIBITED. OFFENDERS WILL BE HELD LIABLE FOR THE PAYMENT OF DAMAGES. ALL RIGHT RESERVED IN THE EVENT OF THE GRANT OF A PATENT, UTILITY MODEL OR DESIGN. (PER ISO 16016)</small>	

REV. K
 SH. 1
 2080-S
 DWG. NO.