

REVISIONS			
REV	DESCRIPTION	DATE	APPROVED
E	REDRAWN - SUPERSEDES 1SA-FJA-REV. "D" FOR 1SA20FJA20. (1) NOTE #1(c) WAS: "CRIMP NUT PER ACES 2409P2."	10-11-95	EN-F16023 DP-24900
F	1) NOTE #1(b) WAS ZINC PLATE PER ACES 2751	2020-06-18 ARK	CO-0204147

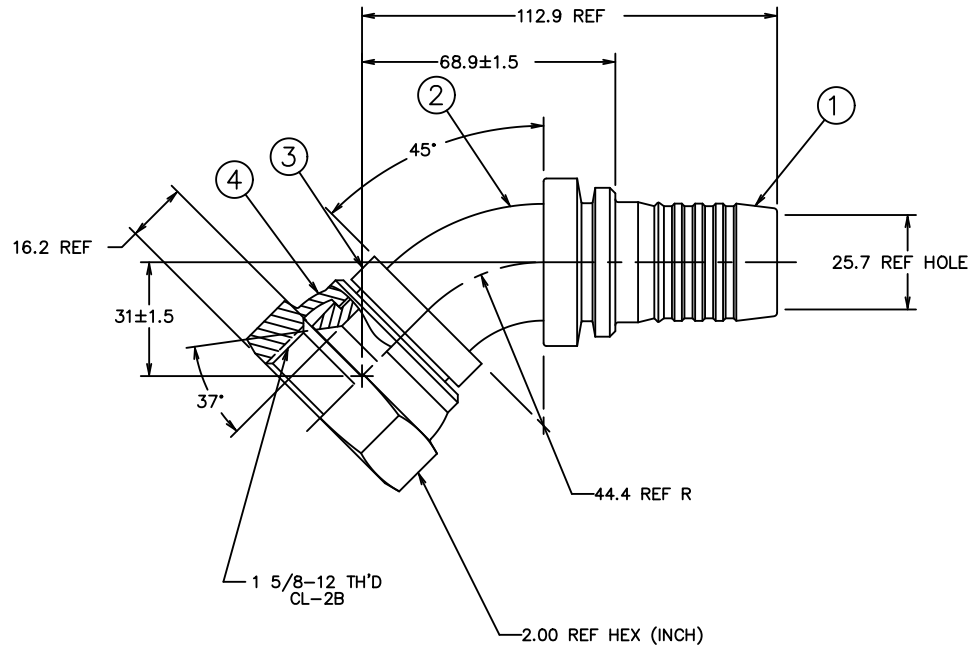

112.9	4.44
68.9±1.5	2.71±.06
44.4	1.75
31±1.5	1.22±.06
25.7	1.01
16.2	.64
MM	INCH

CONVERSION

METRIC

1SA20FJA20	1F40014-2020AB	FC2965-20S	FC2775-2020S	210204-20S
AEROQUIP PART NUMBER	① NIPPLE	② ELBOW	③ SHOULDER	④ NUT
LIST OF MATERIALS				
ITEM NO.	MATERIAL	DRAWN K.PADGETT CHECKED R.D. GARRETT APPROVED R.D. GARRETT RELEASE DATE 1995-10-12 EN-F16023 DP-24900 THIRD ANGLE PROJECTION		
1	STEEL	FLUID CONVEYANCE DIVISION DRAWING TITLE <b>NIPPLE ASSEMBLY</b> 45° SAE 37° SWIVEL 2781 HOSE SIZE A2 DRAWING NUMBER 1SA20FJA20 REV F SCALE 1/1 DIST U CAGE CODE 01276 SHEET 1		
2	STEEL			
3	STEEL			
4	STEEL			
THE REPRODUCTION, DISTRIBUTION AND UTILIZATION OF THIS DOCUMENT AS WELL AS THE COMMUNICATION OF ITS CONTENTS TO OTHERS WITHOUT EXPLICIT AUTHORIZATION IS PROHIBITED. OFFENDERS WILL BE HELD LIABLE FOR THE PAYMENT OF DAMAGES. ALL RIGHT RESERVED IN THE EVENT OF THE GRANT OF A PATENT, UTILITY MODEL OR DESIGN. (PER ISO 16016)				

② CAN BE MADE FROM TUBING PER SPECIFICATIONS ON ELBOW DRAWING.

1. PROCESS AS FOLLOWS:  
 (a) BRAZE PER ACES 2814.  
 (b) ZINC PLATE PER ES 2751DB.  
 (c) CRIMP NUT PER ACES 2813.

① ①