

REVISIONS			
REV	DESCRIPTION	DATE	APPROVED
E	REDRAWN - SUPERSEDES 1SA-FJA-REV. "D" FOR 1SA10FJAB. (1) WAS 13.7 REF.	10-9-95	EN-F16023 DP-24900
F	(1) NOTE #1 (b) WAS - ZINC PLATE PER ACES 2751".	2020-05-28 AKG	CO-0203630

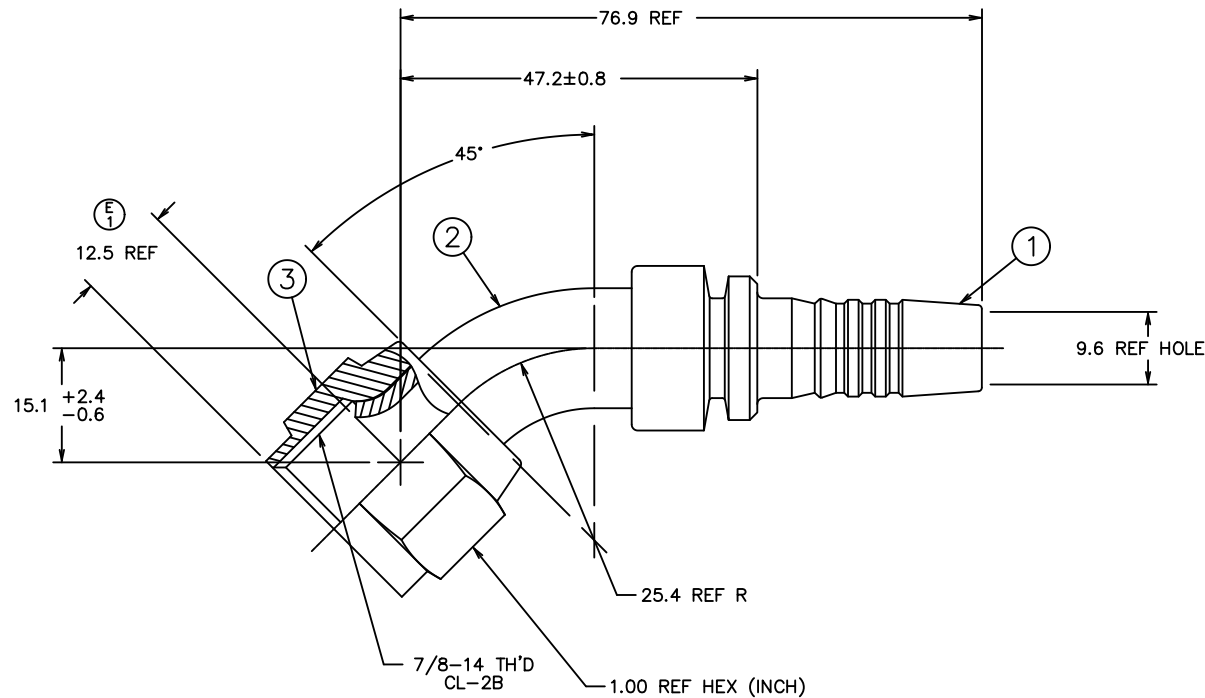

76.9	3.03
47.2±0.8	1.858±.031
25.4	1.00
15.1 +2.4/-0.6	.59 +.10/-0.02
12.5	.49
9.6	.38
MM	INCH

CONVERSION

METRIC

② CAN BE MADE FROM TUBING PER SPECIFICATIONS ON ELBOW DRAWING.

1. PROCESS AS FOLLOWS:

(a) BRAZE PER ACES 2814.

(b) ZINC PLATE PER ES 2751D8. ①

(c) ASSEMBLE NUT AND FLARE ELBOW PER FF481.

1SA10FJAB	1F40014-1008AB	1F40017-10-01AB	210221-10S		
AEROQUIP PART NUMBER	① NIPPLE	② ELBOW	③ NUT		
LIST OF MATERIALS					
ITEM NO.	MATERIAL	DRAWN K. PADGETT	FLUID CONVEYANCE DIVISION DRAWING TITLE <b>NIPPLE ASSEMBLY</b> 45°, SAE 37° SWIVEL 2781 HOSE		
1	STEEL	CHECKED R. GARRETT			
2	STEEL	APPROVED R. GARRETT			
3	STEEL	RELEASE DATE 1995-10-12			
		EN-F16023	SIZE A2	DRAWING NUMBER 1SA10FJA8	REV F
		DP-24900	SCALE 2/1	DIST U	CAGE CODE 01276
		THIRD ANGLE PROJECTION	SHEET 1		
<small>THE REPRODUCTION, DISTRIBUTION AND UTILIZATION OF THIS DOCUMENT AS WELL AS THE COMMUNICATION OF ITS CONTENTS TO OTHERS WITHOUT EXPLICIT AUTHORIZATION IS PROHIBITED. OFFENDERS WILL BE HELD LIABLE FOR THE PAYMENT OF DAMAGES. ALL RIGHT RESERVED IN THE EVENT OF THE GRANT OF A PATENT, UTILITY MODEL OR DESIGN. (PER ISO 16016)</small>					