

REVISIONS			
REV	DESCRIPTION	DATE	APPROVED
B	REDRAWN - SUPERSEDES 1GA_FJB_ REV. "A" FOR 1GA8FJB8 (1) WAS 12.8 REF	12-15-95	EN-F16131 DP-24900
C	(1) DIMN. 36±1.5 WAS 36±0.8 AND 1.417±.06 WAS 1.417±.031	07-07-31 KKP/ADN	0006851-ECO

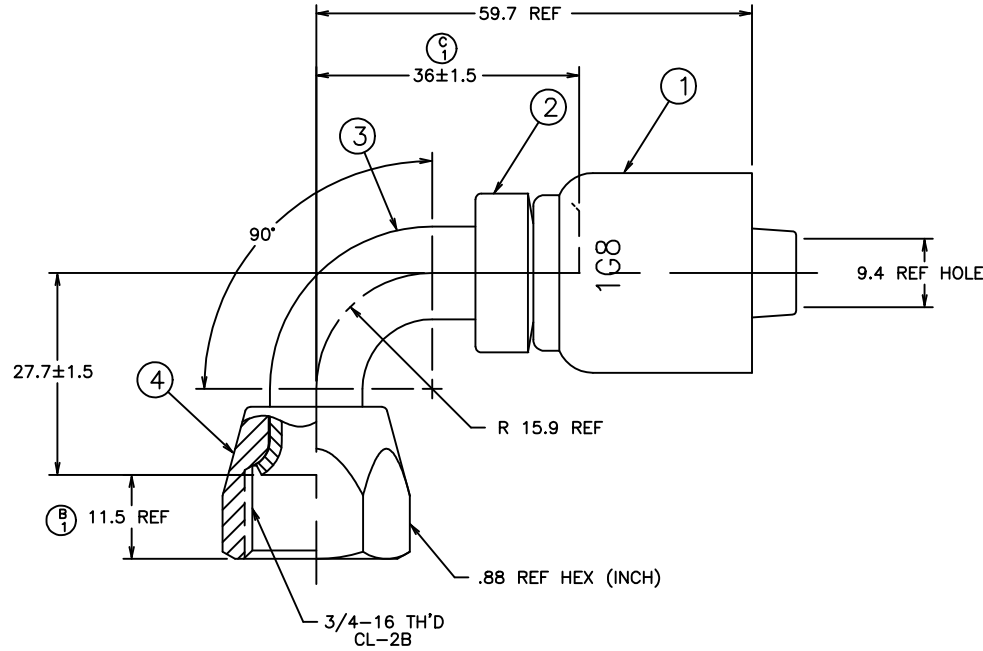

59.7	2.35	
36±1.5	1.417±.06	(C) 1
27.7±1.5	1.09±.06	
15.9	.63	
11.5	.45	
9.4	.37	
MM	INCH	
CONVERSION		

METRIC

1GA8FJB8	1G8	1F40014-0808AB	1F40016-08-01AB	210221-8S
PART NUMBER	(1) SOCKET	(2) NIPPLE	(3) ELBOW (3)	(4) NUT
LIST OF MATERIALS				
ITEM NO.	MATERIAL	DRAWN J.L. HUFFMAN CHECKED R. GARRETT APPROVED R. GARRETT RELEASE DATE 12-13-95 EN-F16131 DP-24900		
1	STEEL	FLUID CONVEYANCE DIVISION DRAWING TITLE FITTING ASSEMBLY 90°, SAE 37° SWIVEL, OTC SIZE A2 DRAWING NUMBER 1GA8FJB8 REV C SCALE 2/1 DIST U CAGE CODE 01276 SHEET		
2	STEEL			
3	STEEL			
4	STEEL			
<small>THE REPRODUCTION, DISTRIBUTION AND UTILIZATION OF THIS DOCUMENT AS WELL AS THE COMMUNICATION OF ITS CONTENTS TO OTHER WITHOUT EXPLICIT AUTHORIZATION IS PROHIBITED. OFFENDERS WILL BE HELD LIABLE FOR THE PAYMENT OF DAMAGES. ALL RIGHT RESERVED IN THE EVENT OF THE GRANT OF A PATENT, UTILITY MODEL OR DESIGN. (PER ISO 18018)</small>				

(3) CAN BE MADE FROM TUBING PER SPECIFICATIONS ON ELBOW DRAWING.

2. 1SA8FJB8 NIPPLE ASSEMBLY MAY BE SUBSTITUTED FOR ITEMS #2, #3 AND #4.

1. PROCESS AS FOLLOWS:

- (a) BRAZE PER ACES 2814.
- (b) ZINC PLATE PER ACES 2751.
- (c) ASSEMBLE NUT AND FLARE ELBOW PER FF481.
- (d) ASSEMBLE SOCKET PER ACES 2813.

DWG. NO. 1GA8FJB8 REV. C