

THE REPRODUCTION, DISTRIBUTION AND UTILIZATION OF THIS DOCUMENT AS WELL AS THE COMMUNICATION OF ITS CONTENTS TO OTHERS WITHOUT EXPLICIT AUTHORIZATION IS PROHIBITED. OFFENDERS WILL BE HELD LIABLE FOR THE PAYMENT OF DAMAGES. ALL RIGHT RESERVED IN THE EVENT OF THE GRANT OF A PATENT, UTILITY MODEL OR DESIGN. (PER ISO 18016)

REVISIONS

REV	DESCRIPTION	DATE	APPROVED
F	REDRAWN & REDESIGNED - LAST REV "E" (WAS BRAZE DESIGN)	8-8-96	EN-F16596 DP-1141

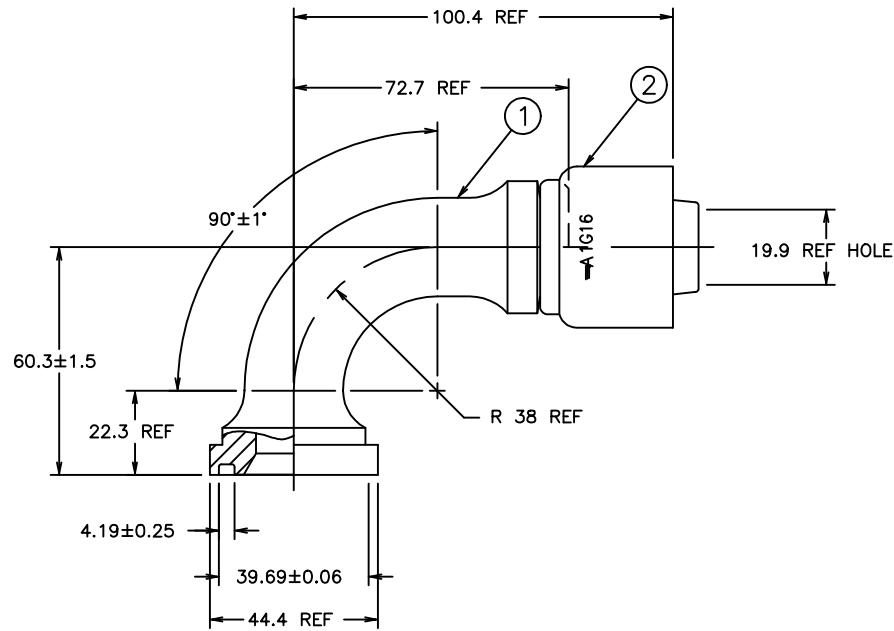

100.4	3.95
72.7	2.86
60.3±1.5	2.37±.06
44.4	1.75
39.69±0.06	1.5625±.0025
39.6	1.56
38	1.50
33.3	1.31
22.3	.88
19.9	.78
4.19±0.25	.165±.010
3	.12
MM	INCH

CONVERSION

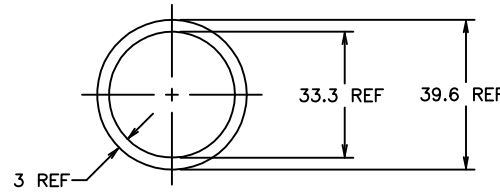

2 O-RING DETAIL

METRIC

3. 1S16FLB16 NIPPLE ASSEMBLY MAY BE SUBSTITUTED FOR ITEM #1.
2. O-RING SHOWN FOR REFERENCE ONLY. SUPPLIED BUT NOT FURNISHED WITH ASSEMBLY.
1. PROCESS AS FOLLOWS:
 - (a) BEND NIPPLE TO DIMENSIONS SHOWN.
 - (b) ZINC PLATE PER ACES 2751.
 - (c) ASSEMBLE SOCKET PER ACES 2813.

ITEM NO.	MATERIAL	DRAWN	CHECKED	APPROVED	RELEASE DATE	SIZE	DRAWING NUMBER	REV
1	STEEL	J.L. HUFFMAN	R.D.GARRETT	R.D.GARRETT	8-9-96	C	1G16FLB16	F
2	STEEL							

FLUID CONVEYANCE DIVISION

DRAWING TITLE
FITTING ASSEMBLY
90°, SPLIT FLANGE TYPE (CODE 61), OTC

EN-F16596 DP-1141	SCALE 1/1	DIST U	CAGE CODE 01276	SHEET NO
-------------------	-----------	--------	-----------------	----------

REV. F
SH. F
DWG. NO. 1G16FLB16

CONVERTED DRAWING CADAM to AutoCAD 18/98