

REVISIONS			
REV	DESCRIPTION	DATE	APPROVED
G	REDRAWN. UPDATED TO LATEST FORMAT & DIMENSION STYLE. 1) ADDED PART #IAAI6PSI6TZ.	2015-12-02 JJS/UPK	0117601-ECO RPS 45748

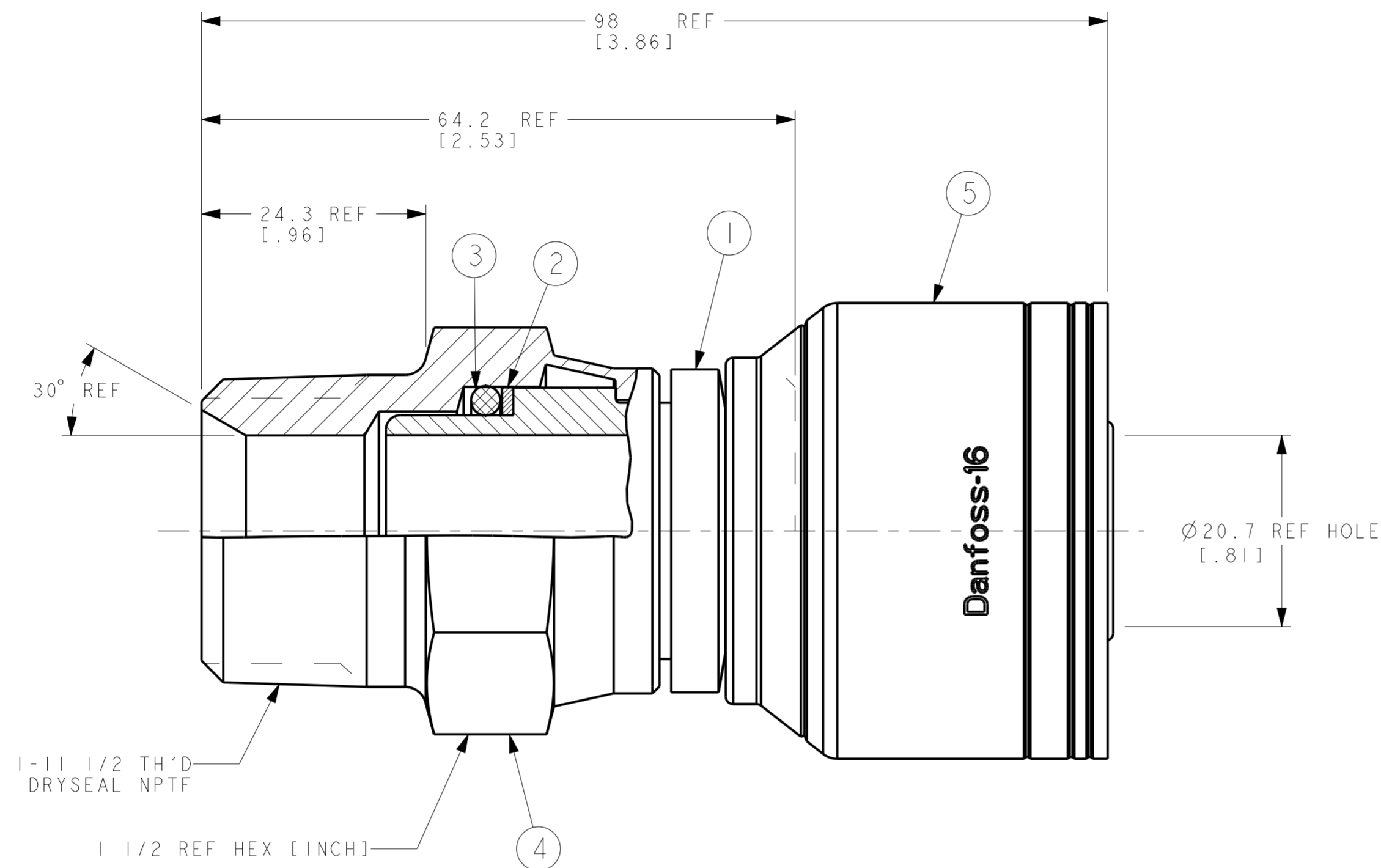

METRIC

①	IAAI6PSI6TZ	IF40005-1616TZ	22049-214	22550-214	503-221033-16-16	1A16TZ
③	IAAI6PSI6	IF40005-1616-S	22049-214	22550-214	221033-16-16S	1A16
	PART NUMBER	① NIPPLE	② BACK-UP RING	③ O-RING	④ NUT	⑤ SOCKET

LIST OF MATERIALS

ITEM NO.	MATERIAL	FLUID CONVEYANCE DIVISION MAUMEE, OHIO U.S.A.	DRAWN J. SONAVANE
1	STEEL		CHECKED U. KADAKOL
2	TEFLON		APPROVED R. RUTSCHILLING
3	NITRILE (BUNA-N)		RELEASE DATE 2015-12-02
4	STEEL		DRAWING INTERPRETATION PER ES 10
5	STEEL		DRAWING TITLE FITTING ASSEMBLY MALE PIPE SWIVEL 1 & 2 WIRE BRAIDED HOSE
		0117601-ECO RPS 45748	CAGE CODE 01276
		THIRD ANGLE PROJECTION	DIST U
		SIZE A2	DRAWING NUMBER IAAI6PSI6
		SCALE 2/1	REV G
		SHEET 1	

③ ISAI6PSI6 NIPPLE ASSEMBLY MAY BE SUBSTITUTED FOR ITEMS #1, #2, #3 AND #4.

2. PROCESS AS FOLLOWS:

- ASSEMBLE NUT PER ES 2409P5 AND 100% INSPECT TO INSURE NUT SWIVELS.
- ASSEMBLE SOCKET PER ACES 2813.

1. DIMENSIONS ARE IN MILLIMETERS [INCHES].

THE REPRODUCTION, DISTRIBUTION, AND UTILIZATION OF THIS DOCUMENT AS WELL AS THE COMMUNICATION OF ITS CONTENTS TO OTHERS WITHOUT EXPLICIT AUTHORIZATION IS PROHIBITED. OFFENDERS WILL BE HELD LIABLE FOR THE PAYMENT OF DAMAGES. ALL RIGHTS RESERVED IN THE EVENT OF THE GRANT OF A PATENT, UTILITY MODEL OR DESIGN. (PER ISO 16016)