

SYM	REVISION	BY	CHK	DATE	ECN
A	ENGINEERING RELEASE	RLL		11-10-87	14736
B	46.0±0.8 WAS 44.4±0.3, 1.81±.03 WAS 1.75±.01	WRD		10-25-96	27993
C	PORT TYPE OPTION WAS "F"	SSD		03-27-07	0004356
D	-1) 44,5±0,4 [1.75±.02] WAS 1.81±.03 / 46,0±0,8 -2) 22,9±0,8 [.90±.03] WAS .90±.02 / 22,9±0,5 -3) PORT DESCRIPTION WAS ".875-14..." -4) UPDATED TO CURRENT FORMAT	CSG	CSG	10-22-09	0020346

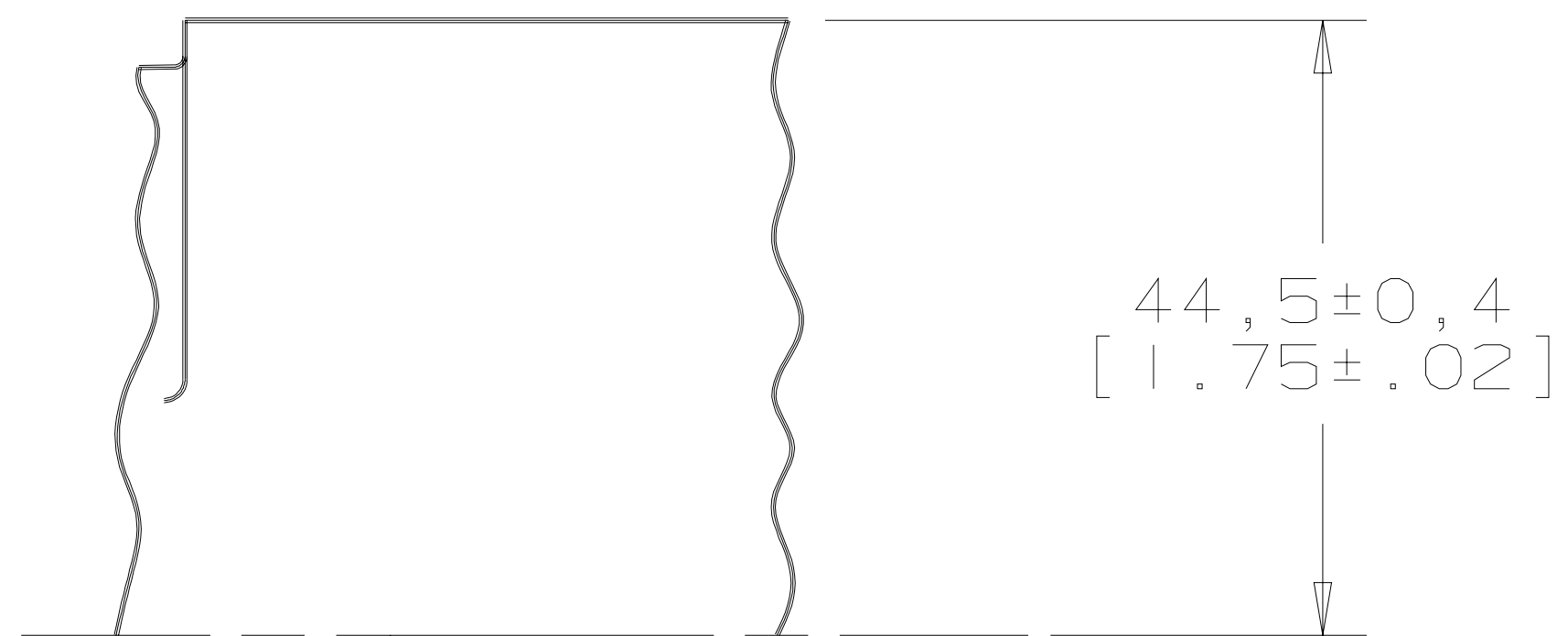

MOTOR CENTERLINE

PORT TYPE

AE = .875-14 O-RING WITHOUT SPOTFACE.

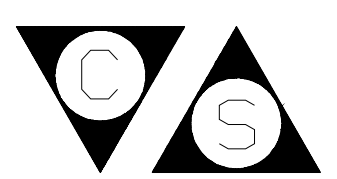

REVIEWED FOR CLASSIFICATION PER ESP-042

UNLESS OTHERWISE SPECIFIED ALL DIMENSIONS ARE IN INCHES <input type="checkbox"/> MILLIMETERS [INCHES] <input checked="" type="checkbox"/>	DRAWING BASED ON ANSI Y14.5M-1982		
	THE REPRODUCTION, DISTRIBUTION, AND UTILIZATION OF THIS DOCUMENT, AS WELL AS THE COMMUNICATION OF ITS CONTENTS TO OTHERS WITHOUT EXPLICIT AUTHORIZATION IS PROHIBITED. OFFENDERS WILL BE HELD LIABLE FOR THE PAYMENT OF DAMAGES. ALL RIGHTS RESERVED IN THE EVENT OF THE GRANT OF A PATENT, UTILITY MODEL, OR DESIGN. (PER ISO 16016)		
TOLERANCES .X ± ---- .XX ± REF .XXX ± ONLY ∠ ± ----°	DRAWN RLL BY/DATE 11-5-87 CHECKED KQ BY/DATE 1-26-88 ENGRG WCW BY/DATE 1-27-88 METALLURGY ---- BY/DATE ----	MATERIAL/HEAT TREAT	
UNSPECIFIED RADII ARE: -----	TITLE PORT INSTALLATION		
UNSPECIFIED DRAFT ANGLES ARE: -----°	<input checked="" type="checkbox"/> THIRD ANGLE PROJECTION <input type="checkbox"/> DO NOT SCALE	MICROINCHES <input type="checkbox"/> MICROMETERS [MICROINCHES] <input checked="" type="checkbox"/> 250/ ARITHMETICAL AVERAGE	NUMBER A-110-006 SCALE 1/1 SHEET 1 OF 1